

Hex and Round Standoffs

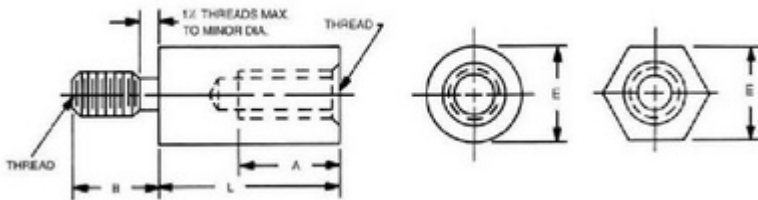

PART NUMBER

XE XXXX - XXX - X - X
 R or H Part No. Thread | Finish
 Round Material
 Or Hex

SUCH AS : R316-2104-256-B-N

Code "E"	Body OD	Part No.	Length	Part No.	Length	Thread Length Code			Code	Material
						Thread	A	B		
108	1/8	2100	5/32	2132	1-5/16	Thread	A	B	A	Aluminum
316	3/16	2101	3/16	2133	1-3/8	2-56	3/16	5/32	B	Brass
104	1/4	2102	7/32	2134	1-7/16	4-40	1/4	3/16	S	Steel
516	5/16	2103	1/4	2135	1-1/2	6-32	3/8	1/4	SS	Stainless Steel
308	3/8	2104	9/32	2136	1-9/16	8-32	7/16	3/8	P	POM
102	1/2	2105	5/16	2137	1-5/8	1032	1/2	3/8		

508	5/8	210 6	11/3 2	213 8	1-11 /16	122 4	1/2	3/8						
304	3/4	210 7	3/8	213 9	1-3/ 4	□	252 0	5/8	1/2		Code	Finish		
		210 8	13/3 2	214 0	1-13 /16	□	311 8	5/8	1/2		PP	Pre-Plating		
		210 9	7/16	214 1	1-7/ 8	□					O	Plain		
		211 0	15/3 2	214 2	1-15 /16	□					Z	Zinc		
		211 1	1/2	214 3	2"						N	Nickel		
		211 2	17/3 2	214 4	2-1/ 8						A	Anodize		
		211 3	9/16	214 5	2-1/ 4						B	Black Oxide		
		211 4	19/3 2	214 6	2-3/ 8						T	Tin		
		211 5	5/8	214 7	2-1/ 2									
		211 6	21/3 2	214 8	2-5/ 8									
		211 7	11/1 6	214 9	2-3/ 4									
		211 8	23/3 2	215 0	2-7/ 8									
		211 9	3/4	215 1	3"									
		212 0	25/3 2											
		212 1	13/1 6	In short lengths, 'A' will be tapped per										
		212 2	27/3 2											
		212 3	7/8	American Sizes										
		212 4	29/3 2	Body Length	3/16	1/4	5/16	3/8	7/16	1/2	9/16	5/8		
		212 5	15/1 6											
		212 6	31/3 2	Thread	Minimum Depth									
		212 7	1"	2-56	.077	.140	□	□	□	□	□	□		
		212 8	1-1/ 16	4-40	.070	.133	.195	□	□	□	□	□		
		212 9	1-1/ 8	6-32	□	.105	.166	.229	.291	□	□	□		

		213 0	1-3/ 16	8-83	□	.090	.152	.215	.277	.340	.402	□	
		213 1	1-1/ 4	10-3 2	□	.078							

Code "E"	Body OD	Part No.	Length	Part No.	Length	Code	Thread	A	B	Code	Material
04	4.5	M2200	5	M2215	20	2545	M2.5x0.45	4.8	3.97	A	Aluminum
06	6	M2201	6	M2216	21	3005	M3x0.5	6.4	4.76	B	Brass
08	8	M2202	7	M2217	22	3506	M3.5x0.6	9.5	6.35	S	Steel
10	10	M2203	8	M2218	23	4007	M4x0.7	11.1	9.53	SS	St Steel
13	13	M2204	9	M2219	24	5008	M5x0.8	12.7	9.53	P	POM
16	16	M2205	10	M2220	25	6010	M6x1.0	15	12.7		
19	19	M2206	11	M2221	28	8012	M8x1.2	15	12.7		
		M2207	12	M2222	31						
		M2208	13	M2223	34					Code	Finish
		M2209	14	M2224	37					PP	Pre-Plating
		M2210	15	M2225	40					O	Plain
		M2211	16	M2226	43					Z	Zinc
		M2212	17	M2227	46					N	Nickel
		M2213	18	M2228	49					A	Anodize
		M2214	19	M2229	52					B	Black Oxide
										T	Tin

In short lengths, 'A' will be tapped per

Body Length	5mm	6mm	7mm	8mm	9mm	10mm	11mm	12mm
Thread	Minimum Depth							
2.5 x 0.45	1.9	2.9	3.9					
3 x 0.5	1.8	2.8	3.8	4.8	5.8			
3.5 x 0.6	1.5	2.5	3.5	4.5	5.5	6.5	7.5	8.5
4 x 0.78-32	1.1	2.1	3.1	4.1	5.1	6.1	7.1	8.1
5 x 0.8	.6	1.6	2.6	3.6	4.6	5.6	6.6	7.6

brass motherboard standoffs

steel standoffs

stainless steel standoffs

aluminum standoffs

brass spacers

brass standoffs signs

brass spacers brass standoffs

brass standoffs board

Brass threaded spacers Standoffs Electronic hardware Lock nuts Stand off nuts round and hex body

Round, hex profiles.

Aluminum, brass, steel, stainless steel, POM.

Threads from 0-80 to 5/16-18.

Lengths from 3/32 to 10 inches.

Diameters from 1/8 to 5/8 inch.

you can send your request with drawing or just popular part number

ADDEESS:

A1metallics INDIA Plot- 1255, GIDC Industrial
Estate, Shanker tekri Jamngar 361004 Gujarat
INDIA

CONTACTS:

PHONE : 91-22-43449300/99

FAX : 91-22-22834046

EMAIL : sales@a1metallics.com

[CONTACT US](#) | [BACK TO HOME PAGE](#)

KEYWORDS:

**Brass standoffs, Nickel plated stand offs , Brass stand off manufacturers,motherboard
standoff, Aluminium standoffs, metric standoffs,Brass standoff suppliers,**